

Model No.: **GPCR123A**

Ultra

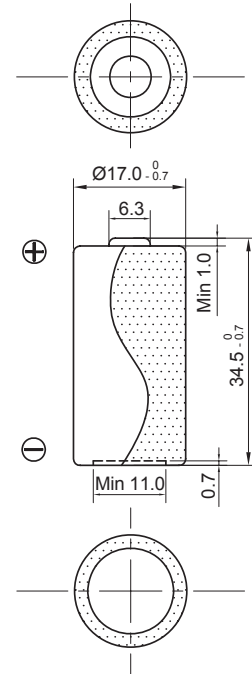

Label Area

Unit : mm

| | |
|------------------------------|--|
| Description | : Consumer Lithium Battery, CR123A |
| Chemical System | : Lithium Manganese Dioxide |
| Nominal Voltage | : 3.0 Volts |
| Nominal Capacity | : 1400mAh @ 10mA to 2.0V at 23°C |
| Dimensions | : Ø17 mm x 34.5 mm |
| Terminals | : Flat, Recessed Negative Terminal |
| Shelf Life | : Up to 10 years |
| Average Weight | : App. 16g |
| Max. Constant Current | : 1400mA |
| Max. Pulse Current | : 3000mA |
| Application | : Smoke Detector, Sensors, Home Security Products, Medical Equipment |
| Operating Temperature | : -40°C to +60°C |
| Standards | : UL1642, UL2054, IEC60086-4, UN38.3 |

Cross References:

| IEC | GP | Panasonic | Energizer | Duracell |
|---------|--------|-----------|-----------|----------|
| CR17345 | CR123A | CR-123A | EL123AP | DL123A |

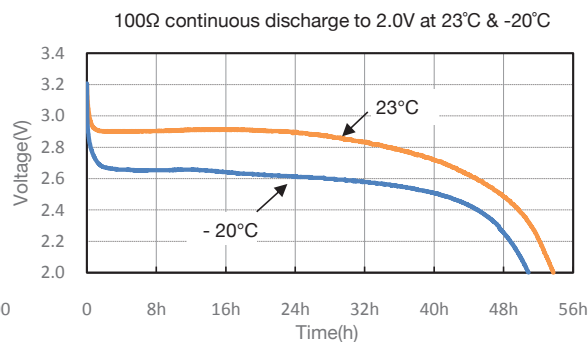
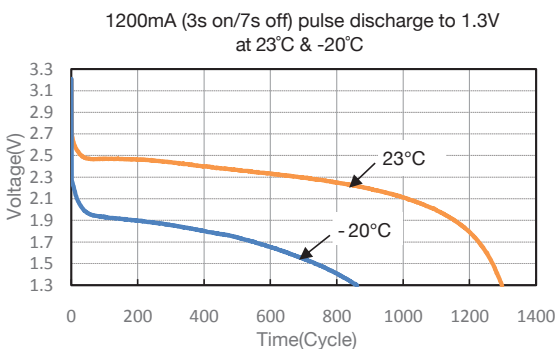
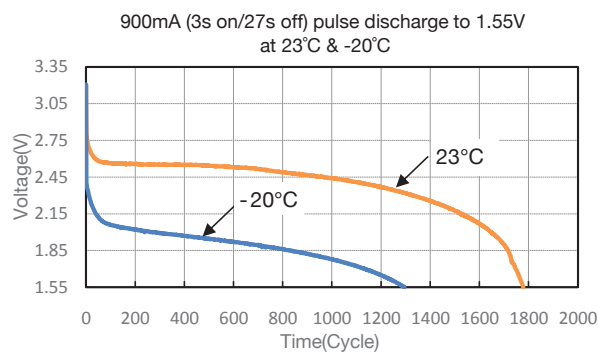
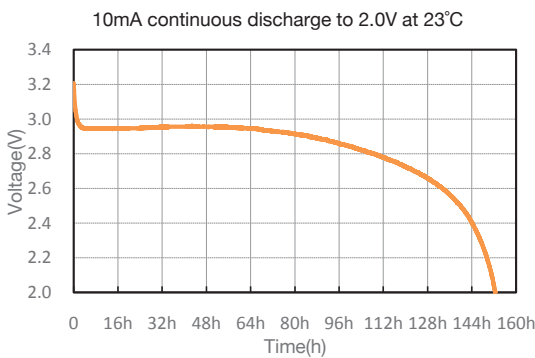

The information (subject to change without prior notice) contained in this document is for reference only and should not be used as a basis for product guarantee or warranty. For applications other than those described here, please consult your nearest GP Sales and Marketing Office or Distributors.

www.gpbatteries.com

Manufacturer reserves the right to alter or amend the design, model and specification without prior notice.
Copyright © GPI International Ltd. - All rights reserved

Member Gold Peak Group